



**Electrolux**  
PROFESSIONAL

## Premium Preparation 2000 mm Storage Cabinet with sliding doors

ITEM # \_\_\_\_\_

MODEL # \_\_\_\_\_

NAME # \_\_\_\_\_

SIS # \_\_\_\_\_

AIA # \_\_\_\_\_



**133103 (AS2000EN)**

Storage Cabinet, with 3  
shelves and 2 sliding doors,  
2000mm

### Short Form Specification

**Item No.** \_\_\_\_\_

Made entirely from 304 AISI stainless steel with welded construction for maximum strength. Inner welded frame in stainless steel. Made up of two stacked tableware storage cabinets, each one fitted with: \* Base shelf in 304 AISI s/s, 1mm in thickness, reinforced by 1,5mm support bars in AISI 304 s/s; \* Intermediate reinforced shelf in 304 AISI s/s that can be positioned at three different heights; \* Two sound-deadened sliding doors in 304 AISI s/s. Six 2"-feet in 304 AISI stainless steel, h=200mm, adjustable in height (-50+20mm).

### Main Features

- Handles in stainless steel for better hygiene and reliability.
- Sturdiness, stability and reliability of table accurately tested.

### Construction

- Inner welded frame in stainless steel to guarantee superior strength and stability.
- Base panel in AISI 304 stainless steel, 10/10 in thickness reinforced by 15/10 support bars in AISI 304.
- Two-piece back panel in 304 AISI stainless steel, 10/10 in thickness.
- Intermediate shelf in stainless steel with riveted corners and trasversal reinforcement in stainless steel.
- 100 mm upstand with 10 mm radioused corner and 13 mm deep, designed to be used against a wall.
- Base panel has 40mm high profile, is 8/10 in thickness with upturned edges and bar reinforcement. It is welded to legs for further structure reinforcement.
- Heavy duty construction entirely in AISI 304 stainless steel to offer maximum durability.
- Two double-walled sliding doors flush fitting to the front of the frame can be removed to facilitate cleaning of the cupboard interior.
- 304 AISI stainless steel feet, 150 mm high and 54 mm in diameter, adjustable by -35/+25 mm.

### Optional Accessories

- Wheel kit for cupboards, 4 wheels (2 with brakes), D=1000 mm PNC 855299 ☐

**APPROVAL:** \_\_\_\_\_



Experience the Excellence  
[www.electroluxprofessional.com](http://www.electroluxprofessional.com)

## Premium Preparation 2000 mm Storage Cabinet with sliding doors

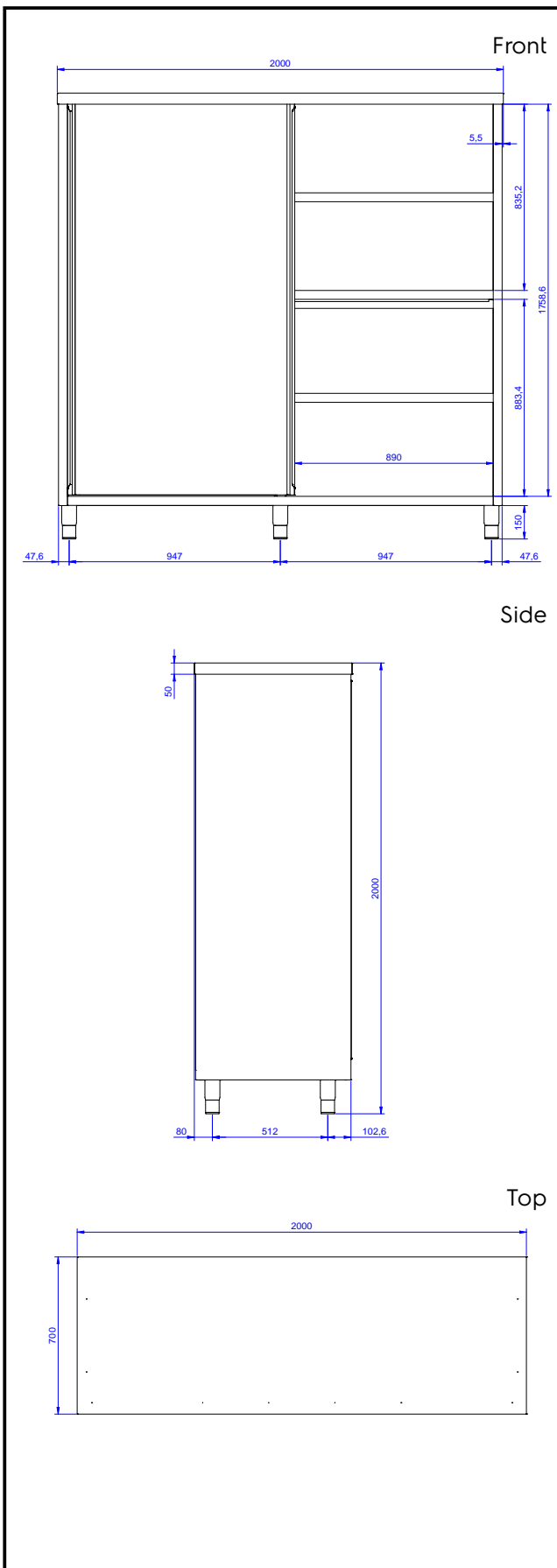

### Key Information:

<b>Cabinet width:</b>	1945 mm
<b>133103 (AS2000EN)</b>	
<b>Cabinet depth:</b>	645 mm
<b>Cabinet height:</b>	1797 mm
<b>External dimensions, Width:</b>	2000 mm
<b>External dimensions, Depth:</b>	700 mm
<b>External dimensions, Height:</b>	2000 mm
<b>Net weight:</b>	140 kg